

Grid Beam

LED TAPE LIGHT

Project Name:

Fixture Type:

DESCRIPTION

All PreciseLED tape light products feature a flexible copper core and are cut and soldered to specified length in our factory. PreciseLED tape lights additionally have best-in-class color rendering, color consistency, and, when combined with our dimming drivers, dimming and flickering performance. Our Grid Beam tape light consists of tightly spaced LEDs that create a seamless light. Its ultra-low profile enables installation practically anywhere. It comes with a 3M adhesive back which makes the installation easy, clean, and safe!

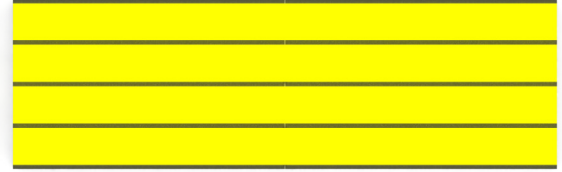

SPECIFICATIONS

- Voltage: 24V
- Watts per foot (15/16" Gridbeam) : 7 W/ft
- Watts per foot (9/16" Gridbeam) : 5 W/ft
- Max Run (15/16" Gridbeam): 11.0 ft
- Max Run (9/16" Gridbeam): 15.4 ft
- Average Lumens per foot: 700.8 lm/ft
- Dimmable using dimmable driver
- Backed with 3M Adhesive
- Ambient Temperature: -4°F ~ +113°F
- Tail end field cuttable every 1.20" inches
- 50,000 Hours Lamp Life
- 3 Step Binning Process
- Protection: IP20
- CRI ≥ 90
- 5 Year Warranty

Please see PreciseLED.com for warranty and installation information.

DIMENSIONS

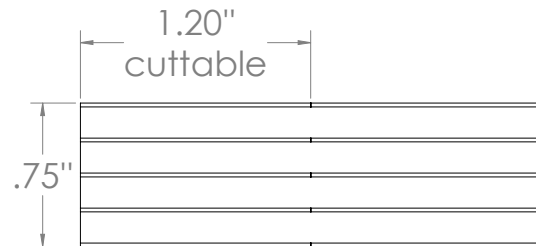

ORDERING CODE

Example: **GDBM-9/16-16'-24V-95C-30L**

Product	Tape Light Size	Spool Length		Volts	CRI	Color Temperature
GDBM	9/16 in. Tapelight 15/16 in. Tapelight	'ft	"in	24V- 24 Volts	90C ≥ 90CRI	27L 2700L 30L 3000L 35L 3500L 40L 4000L
	Custom Length					

COMPATIBLE TAPE LIGHT DRIVERS

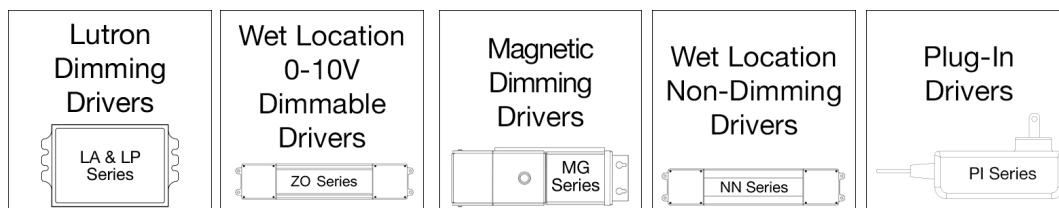

Click [here](#) for a more detailed Driver Overview.

Grid Beam

LED TAPE LIGHT

Project Name:

Fixture Type:

■ WIRING CONFIGURATIONS

These are the available wiring configurations for the tape light. Solder points are secured with heat shrink tube.

Custom Tail Wire Length

Part #: GDBM-xxTAIW

Custom Lead Wire Length

Part #: GDBM-xxLEAW

Tail Jumper Cable

Part #: GDBM-xxJUMP

Rear Feed

Part #: GDBM-xxREAR

xx - xx inches
Default wire length is 12"

■ COMPATIBLE TAPE LIGHT CHANNELS

9/16 IN ZNLT-GRID

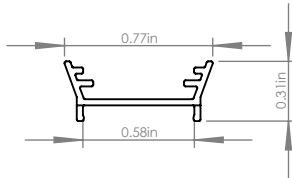

9/16 ZNLT-GRID

Dimensions: 0.77"W x 0.31"H

15/16 IN ZNLT-GRID

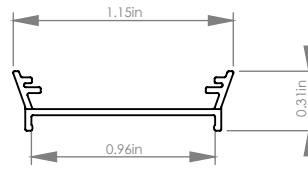

15/16 ZNLT-GRID

Dimensions: 1.15"W x 0.31"H