

3" Linear LED luminaire- T-bar Mount

Project Name:

Fixture Type:

DESCRIPTION

The STUD™ is our most popular linear fixture. It is also the most flexible, allowing you to choose between recessed, surface or pendant mounted options with same extrusion. With the ability to connect one STUD™ to another, there's not much you can't do with this fixture.

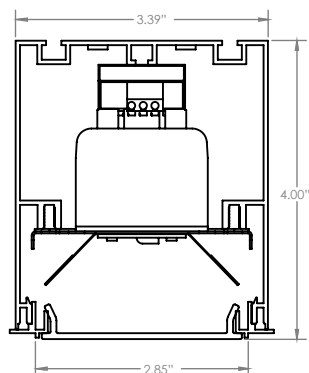
DIMENSIONS

LUMEN PERFORMANCE

CCT	80CRI Lumen Output Multiplier	90 CRI Lumen Output Multiplier	95 CRI Lumen Output Multiplier
2700K	0.906	/	0.651
3000K	0.925	0.728	0.691
3500K	0.964	0.743	0.711
4000K	1	0.756	0.748

Input Watts	Nominal Delivered Lumen Output	Efficacy
LLW 5W/ft	497 lm/ft	99 lm/W
SLW 7.5W/ft	735 lm/ft	98 lm/W

Performance based on 80 CRI, 4000K

SAMPLE LUMEN ADJUSTMENT CALCULATION

HLW 9.38W/ft, 3000K, 90CRI

Lumen Adjustment Multiplier = 0.728

Light Output lm/ft = 896 lm/ft x 0.728 = 652 lm/ft

Efficacy = 896lm/ft / 9.38W/ft = 70 lm/W

ORDERING CODE
Example: **STUD3-2-SLW-TB9-27K-WH-STD-90C-ST-EM**

Product	Length	Watts	Mounting Type	Color Temperature	Finish
STUD3					
STUD3	2 2 feet 4 4 feet 8 8 feet XX Custom Length System Run* length with any inch increment Custom length with any inch increment (18 inch minimum length)	SLW Standard 7.5W/ft LLW Low 5W/ft HLW High 9.38W/ft CLW Custom W/ft Custom watts/ft with max. 9.38W/ft Consult factory for details	TB9 T-bar 9/16" TB15 T-bar 15/16" TG9 Tegular 9/16" TG15 Tegular 15/16" ST Screw slot T-bar	27K 2700K 30K 3000K 35K 3500K 40K 4000K	WH Matte White XX Custom Power Coating Consult factory for colors
Optics	CRI	Driver	Optional	IC Control (Optional)	
STD Standard lens DRP Drop lens	80C 80CRI 90C 90CRI 95C 95CRI Default CRI: 90C	ST Standard LES Lutron 1% Eco System with Soft-on, Fade-to- Black	EM Emergency Driver 6WH120 6 feet control whips-120V 6WH277 6 feet control whips-277V	DS Daylight sensor OS Occupancy sensor DOS Daylight & occupancy sensor	

SPECIFICATIONS

LED SYSTEM

WATTS: 5 W/ft, 7.5 W/ft, 9.38 W/ft

- COLOR TEMPERATURE: 2700K, 3000K, 3500K, 4000K, RGBW
- LUMENS OUTPUT: 3 lumens output options STANDARD, LOW, HIGH as well as custom lumens output are available
- CRI: Minimum 90 color rendering index with an option of 95 CRI
- COLOR consistency: 3-step binning LEDs

OPTICS

Frosted snap-in spotless lens.

ELECTRICAL

Standard driver is a 120V/277V Constant current fully dimmable driver using 0-10V (down to 1%), dimming source current 150 μ A

LES driver is a Hi-lume EcoSystem with Soft-on, Fade-to-Black LED Driver, dim down to 1% and fade smoothly between 0%-1% is fully accessible from below the ceiling.

- FEED: Standard 18-gauge/5 conductor single circuit feed. Optional 6' 120V/277V flex conduit whips available.
- EMERGENCY: Optional remote emergency driver

CONSTRUCTION

- WEIGHT: surface/pendant 1.55 lbs/ft
recessed fixture 1.95 lbs/ft
- HOUSING: Precision-cut extruded aluminum housing.
- HOUSING FINISH: Standard power-coated matte white. Consult factory for custom power coating finish.
- QUICK CONNECTOR: Push-in quick connectors allow fixtures to be joined together for a long run with only one input power wiring.

MOUNTING

- END CAPS: Die-formed steel end caps add 1/8" to each end of fixture.
- SPACKLE FLANGE: Extruded aluminum (0.0475" nominal).
- REFLECTORS: Die-formed steel reflectors with high reflectance glossy white powder coat finish, 60 degree beam spread.

FIXTURE LENGTH

Individual Run: Nominal length of 2ft (23.75"), 4ft(47.75"), 8ft (94.75") as well as custom length are available down to inch increment with 18" minimum length.

*System Run: A seamless connection system of continuous runs. Runs of STUD3 that are longer than 8' in length are designated as System Run. 90-degree mitered corner are available for inside/outside and zig-zag corners.

- APPROVALS: UL/C-UL listed-E493134
Suitable for damp location
IC rated for recessed mount insulated ceiling
- WARRANTY: 5 Year Limited Warranty
- LIFE: > 50,000 hours at 70% lumen maintenance (L70)



MOUNTING

9/16" T-Bar Mount

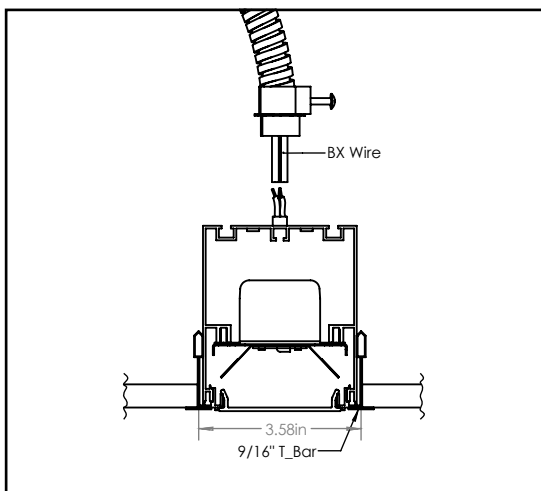

15/16" T-Bar Mount

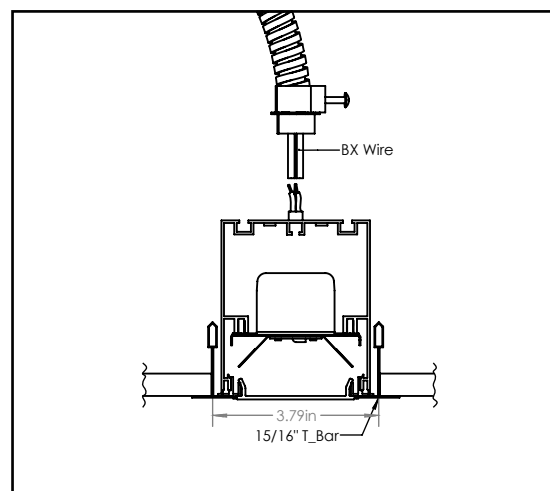

SYSTEM RUN

Quick-wire connection system allows STUD3 to be joined together with only one line power input to the continuous system runs. The STUD3 unit with line power input is connected to next unit with quick-wire connectors.

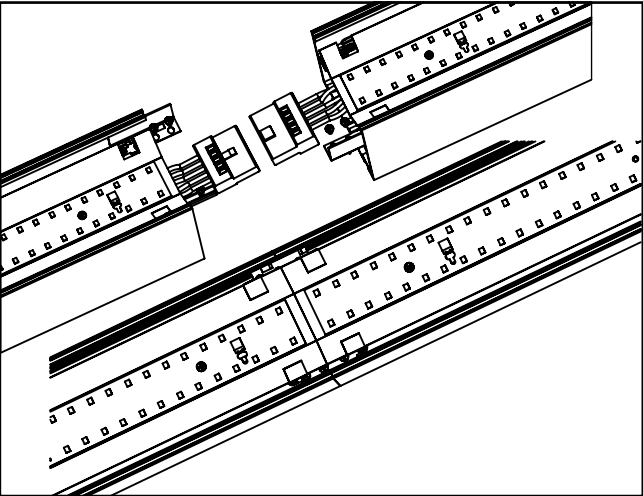

CORNER RUN

STUD3 has the ability to connect corners to form custom rectangular or L-shaped pendant fixtures.

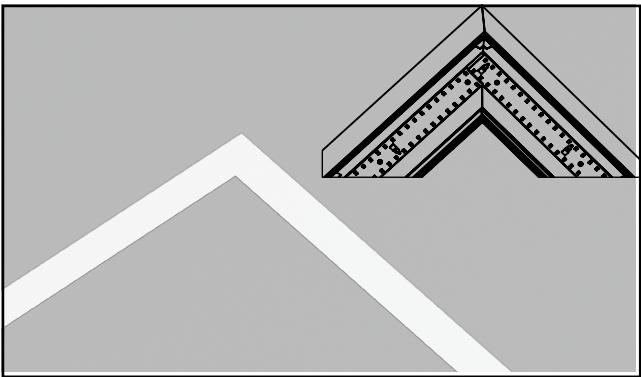

NOTE: Mount each system segment individually prior to joining them together

DIMMER COMPATIBILITY CHART

Standard Driver ST					
Dimmer Manufacturer	Product	Part Number	Dimming Range	Qty Fixture Per Control	Dimming Type
120V/277V					
Lutron	Diva	DVSTV/ DVSCSTV	100%-1%	1-14	0-10 V
Lutron	Nova T	NTSTV-DV	100%-1%	1-14	0-10 V
Lutron	Nova	NFTV*	100%-1%	1-14	0-10 V

* NFTV “DIMMING ONLY” or “USE WITH PowerPack for Dimming+on/off”

PHOTOMETRIC DATA

Luminous Intensity Distribution Diagram

Luminaire: STUD3 4 feet
 Watts: 20W (5W/ft)
 Total delivered lumens: 1445 lm (362 lm/ft)
 CCT: 3000K
 CRI: 90C

IES FILE: STUD3-4-20W-SM-WH-30K-STD-90C-ST

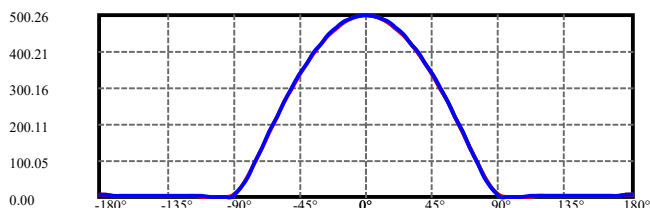
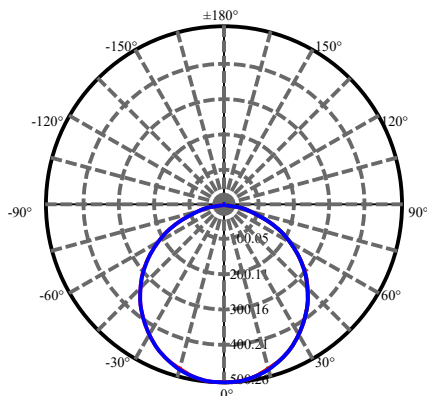

C0(Max): ———
 C0/C180: ———
 C90/C270: ———
 Field angle(10%Imax):C0/180Left:80.7 Right:80.7
 :C90/270Left:80.5 Right:80.5
 Beam Angle(50%Imax):C0/180Left:56.3 Right:56.3
 :C90/270Left:56.4 Right:56.4

ZONAL LUMEN SUMMARY

ZONE	LUMENS	% LUMINAIRE
0-30	387.7	26.8%
0-40	635.2	43.9%
0-60	1,125.6	77.9%
60-90	305.3	21.1%
70-100	129.28	.9%
90-120	4.40	.3%
0-90	1,430.9	99%
90-180	14.61	%
0-180	1,445.6	100%

FLOOD SUMMARY

	EFFICIENCY	LUMENS	HORIZONTAL SPREAD	VERTICAL SPREAD
FIELD (10%):	97.3%	1,406.8	161.4	161.1
BEAM (50%):	72.2%	1,044.2	112.6	112.9
TOTAL:	99%	1,431.0		

ILLUMINANCE AT A DISTANCE

	CENTER BEAM	BEAM SPREAD(FT)	FIELD SPREAD(FT)
HEIGHT(FT)	FOOTCANDLE	HORIZONTAL VERTICAL	HORIZONTAL VERTICAL
4.00	31.27 FC	12.0 12.14	8.94 8.1
8.00	7.82 FC	24.0 24.1	97.7 96.1
12.00	3.47 FC	36.0 36.21	46.61 44.2
16.00	1.95 FC	48.04 8.2	195.4 192.3
20.00	1.25 FC	60.0 60.32	44.3 240.3
		BEAM ANGLE	FIELD ANGLE
		112.6° 112.9°	161.4° 161.1°

PHOTOMETRIC DATA

Luminous Intensity Distribution Diagram

Luminaire: STUD3 4 feet
 Watts: 30W (7.5W/ft)
 Total delivered lumens: 2140 lm (535 lm/ft)
 CCT: 3000K
 CRI: 90C

IES FILE: STUD3-4-30W-SM-WH-30K-STD-90C-ST

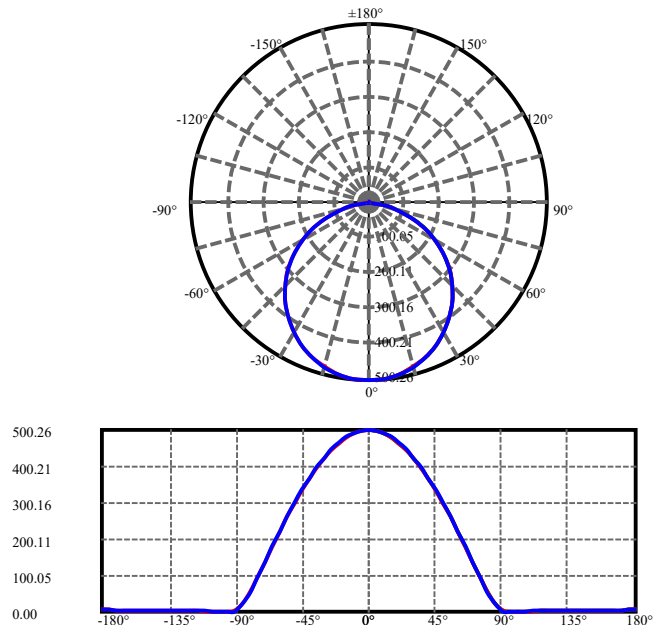

C0(Max): ———
 C0/C180: ———
 C90/C270: ———
 Field angle(10%Imax):C0/180Left:80.7 Right:80.7
 :C90/270Left:80.5 Right:80.5
 Beam Angle(50%Imax):C0/180Left:56.3 Right:56.3
 :C90/270Left:56.4 Right:56.4

ZONAL LUMEN SUMMARY

ZONE	LUMENS	% LUMINAIRE
0-30	573.9	26.8%
0-40	940.3	43.9%
0-60	1,665.9	77.9%
60-90	452.0	21.1%
70-100	191.48	.9%
90-120	6.70	.3%
0-90	2,117.8	99%
90-180	22.01	%
0-180	2,139.8	100%

FLOOD SUMMARY

	EFFICIENCY	LUMENS	HORIZONTAL SPREAD	VERTICAL SPREAD
FIELD (10%):	97.3%	2,082.2	161.7	161.5
BEAM (50%):	72.2%	1,545.1	112.5	112.8
TOTAL:	99%	2,117.9		

ILLUMINANCE AT A DISTANCE

	CENTER BEAM	BEAM SPREAD(FT)	FIELD SPREAD(FT)
HEIGHT(FT)	FOOTCANDLE	HORIZONTAL VERTICAL	HORIZONTAL VERTICAL
4.00	46.29 FC	12.0 12.0	49.7 49.1
8.00	11.57 FC	24.0 24.1	99.3 98.2
12.00	5.14 FC	35.9 36.1	149.0 147.4
16.00	2.89 FC	47.9 48.2	198.7 196.5
20.00	1.85 FC	59.9 60.2	248.3 245.6
		BEAM ANGLE	FIELD ANGLE
		112.5° 112.8°	161.7° 161.5°

PHOTOMETRIC DATA

Luminous Intensity Distribution Diagram

Luminaire: STUD3 4 feet
 Watts: 37.5W (9.38 W/ft)
 Total delivered lumens: 2607lm (652 lm/ft)
 CCT: 3000K
 CRI: 90C

IES FILE: STUD3-4-37.5W-SM-WH-30K-STD-90C-ST

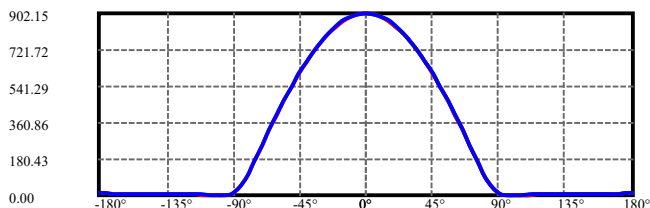
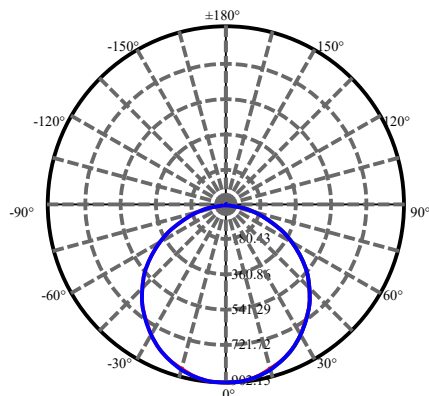

C0(Max): ———
 C0/C180: ———
 C90/C270: ———
 Field angle(10%Imax):C0/180Left:80.6 Right:80.6
 :C90/270Left:80.6 Right:80.6
 Beam Angle(50%Imax):C0/180Left:56.4 Right:56.4
 :C90/270Left:56.4 Right:56.4

ZONAL LUMEN SUMMARY

ZONE	LUMENS	% LUMINAIRE
0-30	699.2	26.8%
0-40	1,145.5	44%
0-60	2,030.1	77.9%
60-90	549.3	21.1%
70-100	231.88	.9%
90-120	8.20	.3%
0-90	2,579.4	99%
90-180	26.91	%
0-180	2,606.3	100%

FLOOD SUMMARY

	EFFICIENCY	LUMENS	HORIZONTAL SPREAD	VERTICAL SPREAD
FIELD (10%):	97.3%	2,535.6	161.3	161.1
BEAM (50%):	72.3%	1,884.3	112.7	112.9
TOTAL:	99%	2,579.5		

ILLUMINANCE AT A DISTANCE

	CENTER BEAM	BEAM SPREAD(FT)	FIELD SPREAD(FT)
HEIGHT(FT)	FOOTCANDLE	HORIZONTAL VERTICAL	HORIZONTAL VERTICAL
4.00	56.38 FC	12.0 12.1	48.6 48.1
8.00	14.10 FC	24.1 24.1	97.2 96.1
12.00	6.26 FC	36.1 36.2	145.8 144.2
16.00	3.52 FC	48.1 48.2	194.3 192.3
20.00	2.26 FC	60.1 60.3	242.9 240.3
		BEAM ANGLE	FIELD ANGLE
		112.7° 112.9°	161.3° 161.1°