

Surface Mount LED Lighting System

Project Name: _____

Fixture Type: _____

DESCRIPTION

STAIRVIEW is setting the standard for reliable, functional lighting for stairways and back-of-house areas. With efficacy over 115 lm/w, it is one of the most efficient light sources available today. Available with sensor and emergency backup options.

SPECIFICATIONS

- Housing: Steel, commercial quality paint coating.
- Optic: PMMA Precision formed optical lens with options of clear lens and diffused lens.
- LED Chip: 2835 approved LM-80 SMD packing, color consistency over time.
- Input: 120-277 VAC 0.22A 25W 60Hz
- Power Factor: 0.98 (at 120V)
- Efficacy: 118-125m/W
- CRI: Ra>80
- Color Temperature: 3000K/4000K
- Driver Output: 42VDC 0.6A
- Dimensions: 23.21" L x 4.70" W x 3.61" H
- Protection Rating: IP20
- Function Optional: Motion Sensor, Emergency Pack
- LED life: 50,000h in 25°C ambient temperature
- Warranty: 5 Year
- Approvals: UL Listed  Suitable for damp locations
- Emergency Battery Type: NiCd 3.6VDC
- Battery Charging time: 48 Hours.
- Emergency Battery Duration: 90 Minutes Min.
- Battery Protections: Output Short Circuit Protection, Battery Over Discharge Protection
- Approval: UL 1310/Class 2/UL924/CEC

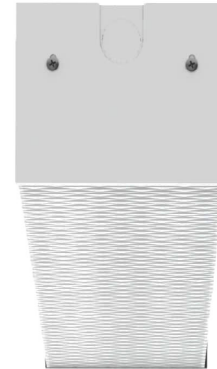

DIMENSIONS

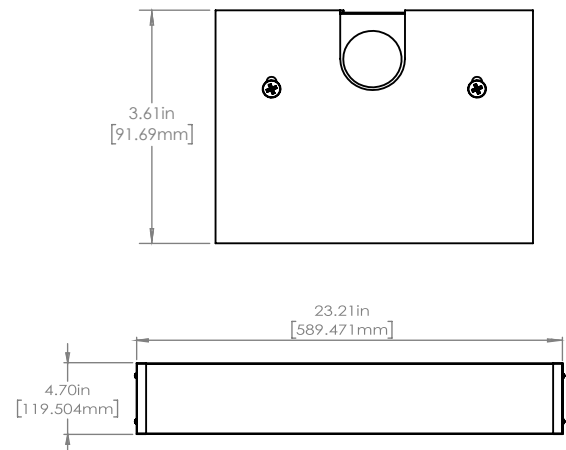

LUMEN OUTPUT PERFORMANCE TABLE

Light Module	Color Temperature	
	3000K	4000K
STVW-2-25W	2700 lm	2900 lm
STVW-2-25W EM	1080 lm	1160 lm

ORDERING CODE

Example: **STVW-2-25W-30K-SM-CL**

Product	Light Module Length Wattage	Color Temperature	Additional Options	Lens
STVW	2-25W			
STVW	2-25W 2 Feet 25 Watts	30K 3000K 40K 4000K	N/A No Option SN Motion Sensor SN-EM Motion Sensor & Emergency Pack	CL Clear Lens DS Diffused Lens

Model	Default	Sensor Activated	EM backup Activated
No Option	Mode A		
SN	Mode B	Mode A	
SN-EM	Mode B	Mode A	Mode C



Setting by Remote Controller (Optional & Order Separately)

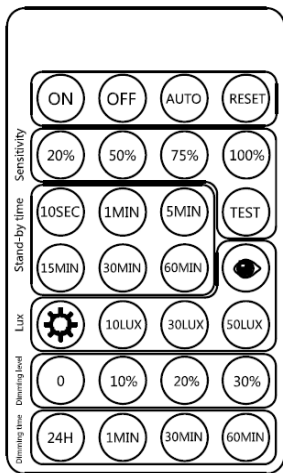

ON OFF	ON= Manual on, after delay time turns to "AUTO" mode OFF= manual off, after delay time turns to "AUTO" mode	TEST	
AUTO	Automatic ON/OFF	RESET	100% 5MIN 20% 60MIN
20% 50% 75% 100%	Detect area	10SEC 10MIN 20MIN 30MIN	Stand-by time before dimming
	Automatic reading and saving of the actual light level	10LUX 30LUX 50LUX	Preselected light values-10to ; Recommendation: rooms with daylight 50 0 lux, without daylight ;
	Dimming level	24H 1MIN 30MIN 60MIN	Dimming time

Dimensions	3.32"L x 2.01"W x 0.26"D
Battery Type	CR2025 x 1

PHOTOMETRIC REPORT

STVW-2-25W-30K

Polar Candela Distribution

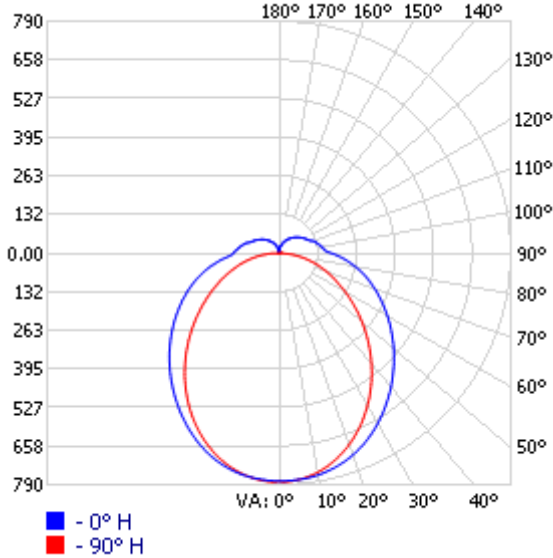

Candela Distribution

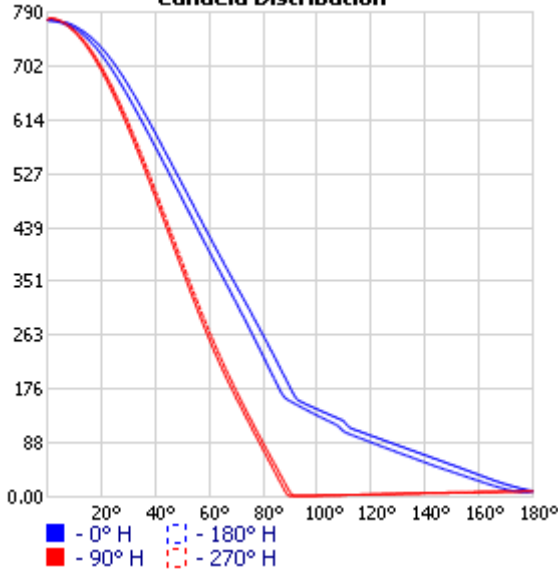

ZONAL LUMEN SUMMARY

ZONE	LUMENS	% LAMP	% LUMINAIRE
0-30	594.3	21.8%	21.8%
0-40	964.0	35.3%	35.3%
0-60	1,699.5	62.2%	62.2%
60-90	680.7	24.9%	24.9%
70-100	476.9	17.5%	17.5%
90-120	238.2	8.7%	8.7%
0-90	2,380.1	87.1%	87.1%
90-180	351.5	12.9%	12.9%
0-180	2,731.6	100%	100%

LUMENS PER ZONE

ZONE	LUMENS	% TOTAL	ZONE	LUMENS	% TOTAL
0-10	73.4	2.7%	90-100	96.7	3.5%
10-20	208.9	7.6%	100-110	80.3	2.9%
20-30	311.9	11.4%	110-120	61.2	2.2%
30-40	369.7	13.5%	120-130	44.8	1.6%
40-50	381.3	14.0%	130-140	31.2	1.1%
50-60	354.1	13.0%	140-150	20.1	0.7%
60-70	300.4	11.0%	150-160	11.3	0.4%
70-80	231.4	8.5%	160-170	4.8	0.2%
80-90	148.9	5.5%	170-180	1.1	0%

ILLUMINANCE AT A DISTANCE

HEIGHT(FT)	CENTER BEAM		BEAM SPREAD(FT)		FIELD SPREAD(FT)	
	FOOTCANDLE	HORIZONTAL	HORIZONTAL	VERTICAL	HORIZONTAL	VERTICAL
2.00	194.34 FC		4.6	7.7	24.0	4.0
4.00	48.59 FC		9.1	15.4	48.1	8.0
6.00	21.59 FC		13.7	23.1	72.1	12.0
8.00	12.15 FC		18.3	30.9	96.1	16.0
10.00	7.77 FC		22.9	38.6	120.2	20.0
12.00	5.40 FC		27.4	46.3	144.2	24.0
14.00	3.97 FC		32.0	54.0	168.2	28.0
16.00	3.04 FC		36.6	61.7	192.3	32.0

BEAM ANGLE		FIELD ANGLE	
97.6°	125.2°	161.1°	90.0°

COEFFICIENTS OF UTILIZATION - ZONAL CAVITY METHOD

EFFECTIVE FLOOR CAVITY REFLECTANCE: 20%

RCC %:	80				70				50				30				10				0
RW %:	70	50	30	0	70	50	30	0	50	30	20	50	30	20	50	30	20	50	30	20	0
RCR: 0	1.16	1.16	1.16	1.16	1.12	1.12	1.12	.87	1.04	1.04	1.04	.97	.97	.97	.90	.90	.90	.87			
1	1.04	.98	.94	.89	1.00	.95	.90	.70	.88	.85	.81	.82	.79	.77	.76	.74	.72	.69			
2	.94	.85	.78	.71	.90	.82	.75	.58	.76	.71	.66	.71	.66	.62	.66	.62	.59	.56			
3	.85	.74	.66	.59	.82	.72	.64	.48	.67	.60	.55	.62	.57	.52	.58	.54	.50	.47			
4	.78	.66	.56	.49	.75	.63	.55	.41	.59	.52	.46	.55	.49	.44	.52	.47	.42	.40			
5	.72	.58	.49	.42	.69	.56	.48	.36	.53	.46	.40	.50	.43	.38	.46	.41	.37	.34			
6	.66	.52	.43	.37	.63	.51	.42	.32	.48	.40	.35	.45	.38	.33	.42	.37	.32	.30			
7	.61	.48	.39	.32	.59	.46	.38	.28	.43	.36	.31	.41	.34	.30	.38	.33	.29	.26			
8	.57	.43	.35	.29	.55	.42	.34	.25	.40	.33	.27	.37	.31	.26	.35	.30	.26	.23			
9	.53	.40	.31	.26	.51	.39	.31	.23	.36	.30	.25	.34	.28	.24	.33	.27	.23	.21			
10	.50	.37	.29	.23	.48	.36	.28	.21	.34	.27	.22	.32	.26	.22	.30	.25	.21	.19			

AVERAGE LUMINANCE (CD/M2)

	0	60	120	180	240	300	360
0	975	975	975	975	975	975	975
45	852	489	475	816	478	491	852
55	843	402	384	799	387	402	843
65	865	325	305	806	307	323	865
75	949	259	234	851	234	254	949
85	1178	186	149	983	150	178	1178

PHOTOMETRIC REPORT

STVW-2-25W-40K

Polar Candela Distribution

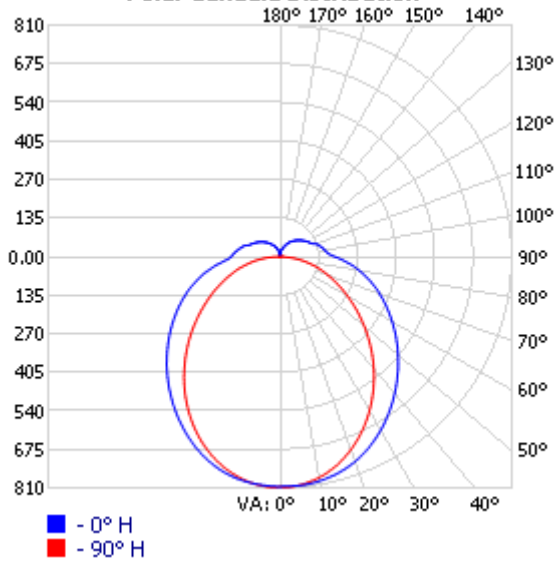

ZONAL LUMEN SUMMARY

ZONE	LUMENS	% LAMP	% LUMINAIRE
0-30	618.5	21.4%	21.4%
0-40	1,005.7	34.8%	34.8%
0-60	1,781.1	61.6%	61.6%
60-90	727.0	25.1%	25.1%
70-100	513.2	17.8%	17.8%
90-120	260.6	9%	9%
0-90	2,508.2	86.8%	86.8%
90-180	382.5	13.2%	13.2%
0-180	2,890.7	100%	100%

LUMENS PER ZONE

ZONE	LUMENS	% TOTAL	ZONE	LUMENS	% TOTAL
0-10	76.1	2.6%	90-100	105.6	3.7%
10-20	217.1	7.5%	100-110	88.0	3%
20-30	325.3	11.3%	110-120	67.0	2.3%
30-40	387.2	13.4%	120-130	48.8	1.7%
40-50	401.2	13.9%	130-140	33.7	1.2%
50-60	374.3	12.9%	140-150	21.6	0.7%
60-70	319.4	11.0%	150-160	11.9	0.4%
70-80	247.2	8.6%	160-170	4.9	0.2%
80-90	160.4	5.5%	170-180	1.1	0%

Candela Distribution

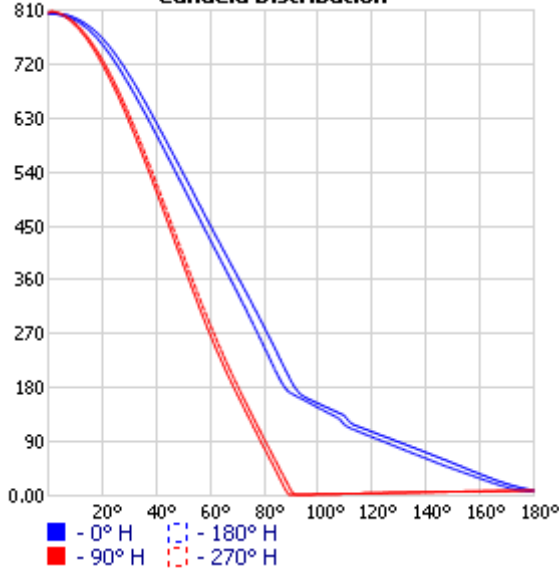

ILLUMINANCE AT A DISTANCE

HEIGHT(FT)	CENTER BEAM		BEAM SPREAD(FT)		FIELD SPREAD(FT)	
	FOOTCANDLE	HORIZONTAL	HORIZONTAL	VERTICAL	HORIZONTAL	VERTICAL
2.00	201.27 FC		4.6	8.2	24.6	4.0
4.00	50.32 FC		9.3	16.4	49.1	8.0
6.00	22.36 FC		13.9	24.6	73.7	12.0
8.00	12.58 FC		18.5	32.8	98.2	16.0
10.00	8.05 FC		23.1	40.9	122.8	20.0
12.00	5.59 FC		27.8	49.1	147.4	24.0
14.00	4.11 FC		32.4	57.3	171.9	28.0
16.00	3.14 FC		37.0	65.5	196.5	32.0

COEFFICIENTS OF UTILIZATION - ZONAL CAVITY METHOD

EFFECTIVE FLOOR CAVITY REFLECTANCE: 20%

RCC %:	80				70				50				30				10				0
RW %:	70	50	30	0	70	50	30	0	50	30	20	50	30	20	50	30	20	50	30	20	0
RCR: 0	1.16	1.16	1.16	1.16	1.12	1.12	1.12	.87	1.04	1.04	1.04	.97	.97	.97	.90	.90	.90	.87			
1	1.04	.98	.93	.89	1.00	.95	.90	.69	.88	.84	.81	.82	.79	.76	.76	.74	.72	.69			
2	.94	.85	.77	.71	.90	.82	.75	.57	.76	.70	.66	.71	.66	.62	.66	.62	.59	.56			
3	.85	.74	.65	.58	.81	.71	.63	.48	.66	.60	.54	.62	.56	.52	.58	.53	.49	.46			
4	.78	.65	.56	.49	.74	.63	.55	.41	.59	.52	.46	.55	.49	.44	.51	.46	.42	.39			
5	.71	.58	.49	.42	.68	.56	.48	.36	.53	.45	.40	.49	.43	.38	.46	.41	.36	.34			
6	.66	.52	.43	.37	.63	.51	.42	.31	.47	.40	.35	.44	.38	.33	.42	.36	.32	.29			
7	.61	.47	.38	.32	.58	.46	.38	.28	.43	.36	.30	.40	.34	.29	.38	.32	.28	.26			
8	.57	.43	.34	.29	.54	.42	.34	.25	.39	.32	.27	.37	.31	.26	.35	.29	.25	.23			
9	.53	.39	.31	.26	.51	.38	.31	.22	.36	.29	.24	.34	.28	.24	.32	.27	.23	.21			
10	.50	.36	.28	.23	.48	.35	.28	.20	.33	.27	.22	.32	.26	.21	.30	.25	.21	.19			

BEAM ANGLE	FIELD ANGLE
98.3°	127.9°
	161.5°
	90.0°

AVERAGE LUMINANCE (CD/M2)

	0	60	120	180	240	300	360
0	1010	1010	1010	1010	1010	1010	1010
45	897	512	498	864	503	517	897
55	892	423	404	850	410	426	892
65	920	343	321	863	327	345	920
75	1012	275	248	918	252	273	1012
85	1259	196	158	1074	163	193	1259