

LED TAPE LIGHT

WARNING



NEVER PLUG IN LOW VOLTAGE TAPE LIGHT INTO LINE VOLTAGE
REMOVE TAPELIGHT FROM SPOOL BEFORE INSTALLATION
PRODUCT SHOULD BE INSTALLED BY A LICENSED ELECTRICIAN

Safety and Warnings

- National and local electrical code regulations should be kept in mind while installing the tape light.
- A qualified licensed electrician is intended to install this product.
- A compatible class 2 power supply must be used for this product.
- Avoid installing in direct sunlight as the LED chips can be damaged by it.
- Do not power the tape light while coiled in the plastic spool, excess heat can damage LEDs.
- Make sure the product isn't surrounded by anything conductive or not rated for high temperatures.
- Different tape light has different voltage ratings, make sure wire length and driver are compatible.
- Handle tape light with care, excessive bending and force can damage tape light.
- Not all tape lights are rated for outdoor/wet location use, check our website for specifications.

Handling Instructions



Can be bent backwards

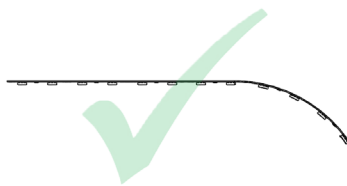

Can be bent forwards

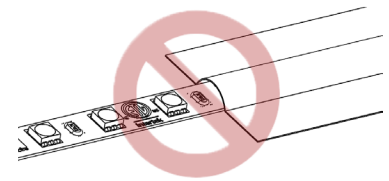

Do not cover tape light with anything

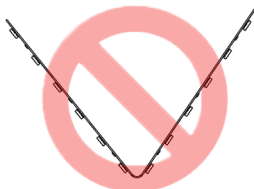

Do not fold or crease



Do not bend vertically up or down

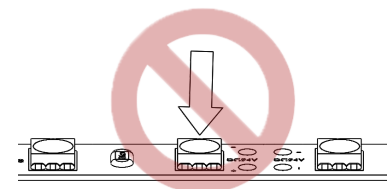

Do not apply force on leds

LED TAPE LIGHT

Before installation, make sure all components are compatible with each other.

1. Determine the proper driver for the tape light.

Please see the following link for detail calculations
<http://preciseled.com/uploads/Driver-Overview.pdf>

2. Cut the tape light to desired length with scissors.
Tapelight can only be cut between the copper pad locations.



Voltage drop

To avoid exceeded voltage drop ($> 3\%$ of applied voltage), applicable wire gauge must be selected based on the length of the wire and the tape light.

Refer to voltage drop charts for wire gauge selection

3. Mount the tape light with 3M adhesive backing

Peel off the back tape from one end and carefully place the tape light along the proper channel. Press the tape light to ensure secure contact with the surface. DO NOT directly press on the LED diode, which could LED connection to the strip.

Ensure the product is lying flat in a straight line and not tangled.

4. Power the tapelight with selected driver.

Ensure the +/- polarity for each connection is correct before powering up the tapelight.

WIRING DIAGRAM

