

# ZENLITE® LOUVRE

Recessed LED Lighting System for New Construction

Project Name:

Fixture Type:

## DESCRIPTION

ZENLITE® LOUVRE is an LED Micro Louver Lighting System for 5/8" Drywall Walls/Ceilings. Our patent-pending design allows for easy installation of this versatile fixture in dry or damp locations. The channel has the ability to connect seamlessly with our ZENLITE® LOUVRE Pendant Mount and Surface Mounted fixtures; as well as switching from trim to smooth lens. To achieve a certain light output, choose between the different available light modules and color temperatures. Light modules are also dimmable when using a dimmable driver. Channel is installed directly to studs with 16-inch spacing screw holes. ZENLITE® LOUVRE is a recessed lighting fixture that can create a unique line of light.

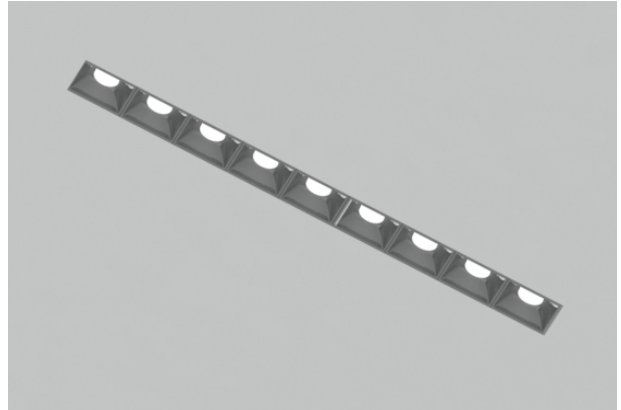

## DIMENSIONS

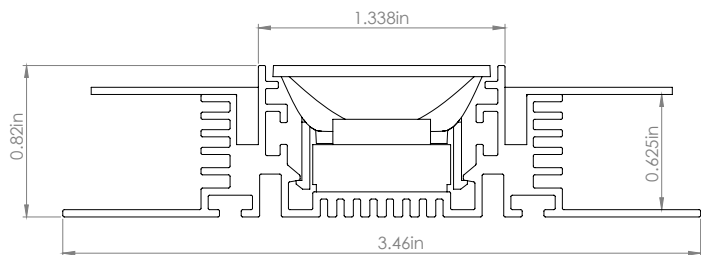

## LUMEN OUTPUT PERFORMANCE

Light Module	Lumens/ft
LVCB	485
LRGW	183
ZGBM	200

Color Temp	27K	30K	35K	40K
Multiplier	0.73	0.82	0.91	1

## ORDERING CODE

Example: ZNLT-LOUV-14-LVCB-24V-90C-27K-90B-T-BK-MG

Product	Length	Light Module   Cuttable Length   Watts Per Feet	Volt	CRI	Color Temp	Beam Spread*
ZNLT-LOUV			24V	90C		
ZNLT-LOUV	<b>XX</b> Length in inches  Lengths can be specified down to 1.18 inch (30mm).  Minimum channel length is <b>6 inches</b> .	<b>LVCB</b> Louvre Cool Beam   1.18 inch   5.8 W/ft ( Louvre use only) <b>LRGW</b> Louvre Beam RGBW   1.18 in   3.6 W/ft ( Louvre use only) <b>ZGBM</b> Zigbeam Module   1.18 inch   4.4 W/ft (Lens use only)  Max length of a Tapelight segment: (Based on Class 2 Circuit Adherence) LVCB- 13.3 Feet LRGW- 21.3 Feet ZGBM- 17.5 Feet  *ZGBM not available in 95CRI at this time <b>Note:</b> Longer lengths are possible, consult info@PreciseLED.com	24V- 24V	90C ≥ 90 CRI	<b>27K</b> 2700K <b>30K</b> 3000K <b>35K</b> 3500K <b>40K</b> 4000K	<b>10X45B</b> degrees <b>30B</b> degrees <b>60B</b> degrees <b>90B</b> degrees  *Beam spread options are not compatible with ZGBM
Trim/Lens	Driver	Housing	Feed Options (Beginning)	Feed Options (End)		

<b>BK</b> Black Trim <b>AZ</b> Clear Alzac Trim <b>DLNS</b> Diffused Lens <b>ALP</b> Aluminum Plate  <b>Note:</b> Consult factory for more details on multiple trim colors	<b>MG</b> (1% Magnetic Dimming) <b>ZO</b> (1% 0-10V Dimming) <b>NN</b> Non Dimming <b>L3</b> Lutron Hi-lume 1% 3-wire/EcoSystem (40W max.) <b>LP</b> Lutron Hi-lume Premier 0.1% Fade To Black EcoSystem/3-wire	<b>ST</b> Standard ( <b>Default</b> ) <b>CP</b> Chicago Plenum	<b>BGNM</b> Beginning Module <b>ENDM</b> End Module <b>SDBX</b> Side BX Connector <b>RRBX</b> Rear BX Connector <b>ENCP</b> End Cap	<b>BGNM</b> Beginning Module <b>ENDM</b> End Module <b>SDBX</b> Side BX Connector <b>RRBX</b> Rear BX Connector <b>ENCP</b> End Cap
---	---	---	---	---

## PRODUCTION OPTIONS (Optional for Lighting designers)

### OPTION A

Ship channels and flanges in 8ft lengths  
(Default for lengths greater than 8 ft)

Note: It will exclude any non-45 degree angles required, which must be cut by PreciseLED factory.

### OPTION B

Precut channels and flanges to desired lengths  
(Default for lengths less than 8ft)

Note: Exact field measurements must be provided, factory does not take responsibility for field measurement errors. Prepunched holes (every 16") in rear of fixture may not match stud location, additional drilling may be required.

### OPTION C

Ship fixture preloaded with LED module

Note: This option is only available for lengths  $\leq 8$  ft. Exact field measurements must be provided, factory does not take responsibility for field measurement errors. Prepunched holes (every 16") in rear of fixture may not match stud location, additional drilling may be required.

Note: **Approved shop drawings needed for custom configurations.**

Aluminum Channels and PVC L-Beads come in a maximum available length of 8 feet. Seamless Lens can be shipped in roll lengths up to 40 feet. For fixture longer than 8ft, multiple 8ft channels need to be joined together by means of straight channel connectors

## FIXTURE COMPONENTS

See installation instruction sheet for further details on how to install the Louvre product.

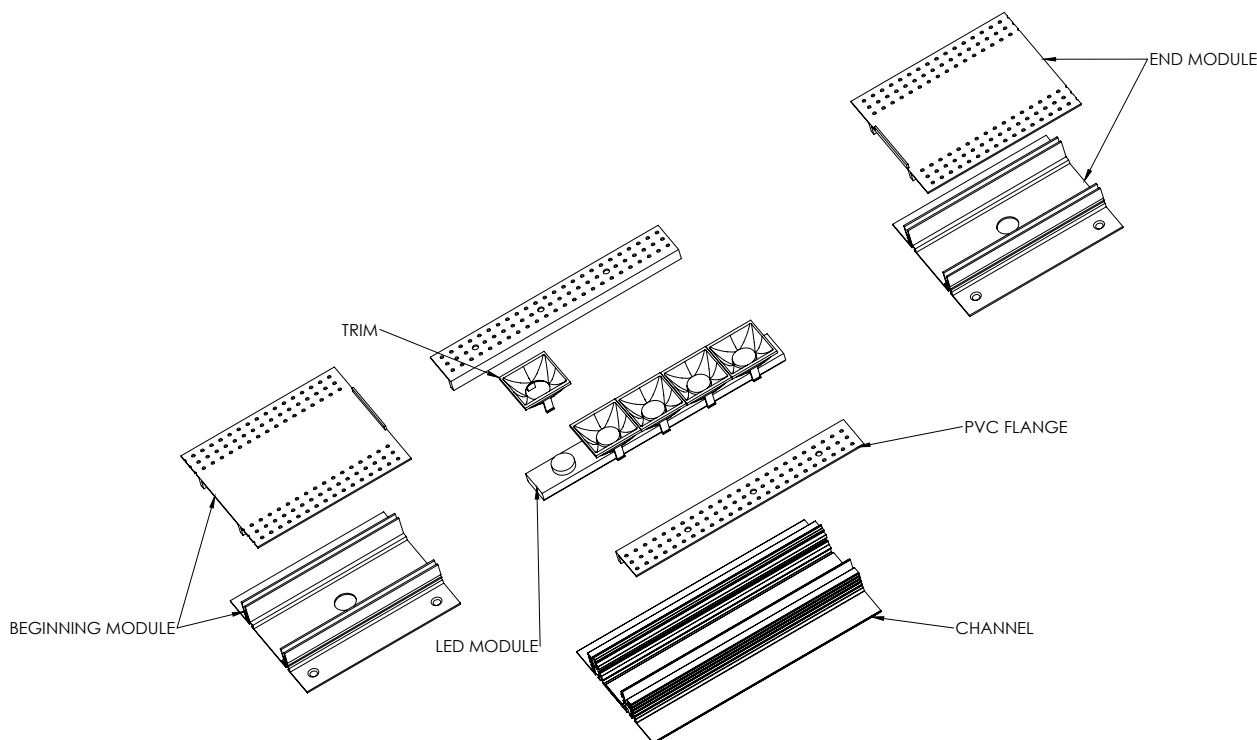

## ■ ADDITIONAL COMPONENTS

These are the certain standard components that comes along with the ZENLITE® Lighting system for 5/8" drywall lighting system.

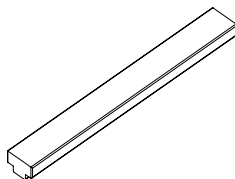

### T-shape Connector

Length: 2 inches  
Purpose: To connect to straight ZENLITE® Channels  
Part #: **ZNLT-CNCT-STRT**

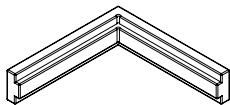

### Outside T-shape Connector

Length: 1 x 1 inches  
Purpose: To connect to straight ZENLITE® Channels at outside wall corners at 90 deg  
Part #: **ZNLT-CNCT-OS90**

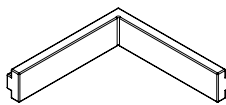

### Inside T-shape Connector

Length: 1 x 1 inches  
Purpose: To connect to straight ZENLITE® Channels at inside wall corners at 90 deg  
Part #: **ZNLT-CNCT-IN90**

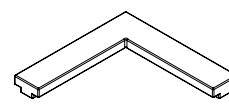

### ZIGZAG T-Shape Connector

Length: 1 x 1 inches  
Purpose: To connect to straight ZENLITE® Channels trimmed at 45 Degrees to form a 90 Degree bend  
Part #: **ZNLT-CNCT-ZG90**

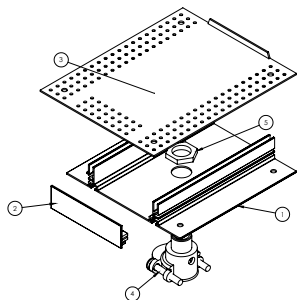

### Beginning Module

Length: 5 inches  
Purpose: To be attached at the beginning of ZENLITE® channel by means of two T-shape connectors

Sub-Components:

1. 4 in Channel
2. End Cap
3. Channel Cover
4. BX Cable Connector
5. BX Connector Nut

Part #: **ZNLT-BGNM-LOUV**

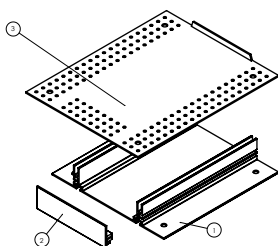

### End Module

Length: 5 inches  
Purpose: To be attached at the beginning of ZENLITE® channel by means of two T-shape connectors

Sub-Components:

1. 4 in Channel
2. End Cap
3. Channel Cover

Part #: **ZNLT-ENDM-LOUV**

## ■ WIRING DIAGRAM

Wiring diagram for a typical installation of the light fixture with a compatible driver and switch.

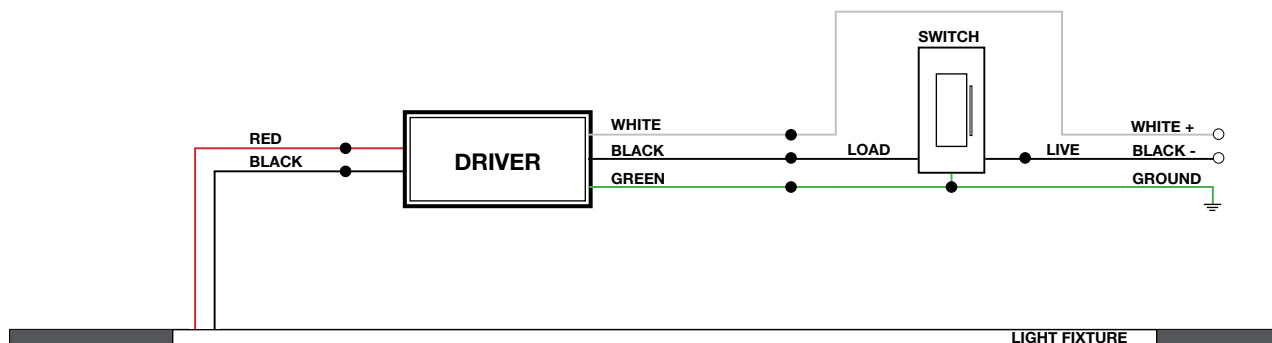

## CUSTOM DESIGN

Enter custom design below using the following notation:

- T - Trim
- P - Plate (unlit)
- L - Lens (lit)

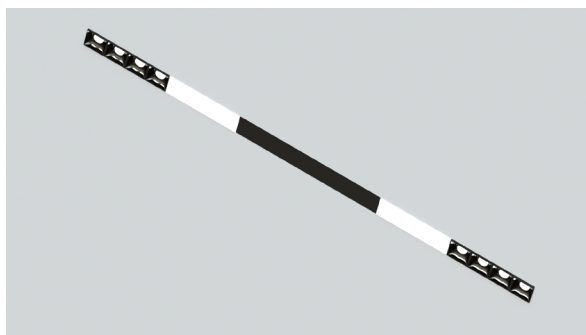

Example: P-L-T

## CUSTOM (leave blank if unneeded)

Type	Length	Light Module [Watts Per Feet]	Volt	CRI	Color Temp	Beam Spread	Trim/ Lens	Driver
<b>T</b>		<b>LVCB</b>	<b>24V</b>					
<b>Trim</b>	<b>XX</b> Length in inches only. Lengths can be specified down to 1.18 inch (30mm).	<b>LVCB</b> Louvre Cool Beam [6 W/ft] <b>LRGW</b> Louvre Beam RGBW [3.6 W/ft]	<b>24V- 24V</b>	<b>90C</b> ≥ 90 CRI	<b>27K</b> 2700K <b>30K</b> 3000K <b>35K</b> 3500K <b>40K</b> 4000K	<b>10X45B</b> degrees <b>30B</b> degrees <b>60B</b> degrees <b>90B</b> degrees	<b>BK</b> Black Trim <b>AZ</b> Clear Alzac Trim	<b>MG</b> (1% Magnetic Dimming) <b>ZO</b> (1% 0-10V Dimming) <b>NN</b> Non Dimming <b>L2</b> Lutron Hi-lume Forward Phase 120V 1% 2-wire (40W max.) <b>L3</b> Lutron Hi-lume 1% 3-wire/Eco System <b>LP</b> Lutron Hi-lume Premier 0.1% Fade To Black EcoSystem/3-wire
<b>L</b>		<b>ZGBM</b>	<b>24V</b>					
<b>Lens</b>	<b>XX</b> Length in inches only. Lengths can be specified down to 1.18 inch (30mm).	<b>ZGBM</b> Zigbeam [4.4 W/ft]	<b>24V- 24V</b>	<b>90C</b> ≥ 90 CRI	<b>27K</b> 2700K <b>30K</b> 3000K <b>35K</b> 3500K <b>40K</b> 4000K	<b>N/A</b>	<b>DLNS</b> Diffused Lens	
<b>P</b>		<b>N/A</b>	<b>N/A</b>	<b>N/A</b>	<b>N/A</b>	<b>N/A</b>		
<b>Plate</b>	<b>XX</b> Length in inches only. Lengths can be specified down to 1.18 inch (30mm).	<b>N/A</b>	<b>N/A</b>	<b>N/A</b>	<b>N/A</b>	<b>N/A</b>	<b>ALP</b> Aluminum Plate	

## ■ SPECIFICATIONS

### LED SYSTEM

The LED system consists of two different light modules to choose from, LVCB and LRGW which are dimmable using a dimmable driver. They consist of lens covered diodes to achieve certain beam spreads. LRGW has the ability to output any color on the color wheel and white light. The light modules are available in four different color temperatures of 2700K, 3000K, 3500K, and 4000K. LVCB has a minimum 90CRI (color rendering index).

### OPTICS / TRIMS

For this fixture, multiple beam spread options are available. The individual precision formed snap-in polycarbonate louvers trims are available in black or clear alzac finish and are field changeable.

### ELECTRICAL

There are six available drivers to choose from. All LED drivers are mounted remotely and have 120-277VAC input.

**MG driver** is a forward phase, 1% magnetic low voltage (dims down to 1%) dimming and flicker free.

**ZO driver** consists of 1% 0-10V dimming, flicker free, and is IP65 rated for both indoor and outdoor use.

**NN driver** is a non dimming, flicker free driver that is IP65 rated for both indoor and outdoor use.

**L3 driver** is a 3-Wire driver from Lutron that has Hi-lume 1% EcoSystem and provides continuous and flicker free dimming from 100%-1%

**LP driver** is a 3-Wire driver from Lutron that has Hi-lume Premier 0.1% FadeToBlack EcoSystem and provides continuous and flicker free dimming down to 0.1% when paired with Ecosystem Lutron controllers.

- FEED: 18" of wire provided with connection to a longer wire inside the beginning module.
- EMERGENCY (Optional): Remote emergency battery pack provides backup power for 90 minutes. Remote emergency test switch included.

### MOUNTING

Proprietary design allows the fixture to be mounted directly onto studs first and accommodates 5/8" drywalls or ceilings. Contains prepunched holes spaced 16" apart with the option for additional holes to be drilled into the rear flange for versatility.

### CONSTRUCTION

- DIMENSIONS: 3.46"W x .82" H
- HOUSING: Anodized aluminum extrusion cut with high precision equipment with up to 98% reflectivity on the inside. PVC flange with low thermal conductivity to prevent heat from spreading to the surface of the paint/spackle.

### LISTING/WARRANTY

- APPROVALS: UL/C-UL listed for dry and damp locations. Suitable for outdoor installations under a canopy or soffit.
- WARRANTY: 5 year limited warranty, ambient temperatures at fixture location should not exceed 40°C during normal operation.
- IP Protection: IP20
- CRI ≥ 90
- 50,000 hours lamp life

