

# ZENLITE® SM2-2G

LED Lighting System for Wood, Stone and other Hard Surfaces

## DESCRIPTION

ZENLITE® SM2 is an LED Lighting System for mounting in or on stone, wood or other hard surfaces. Our patent-pending design allows for projection of clean horizontal, vertical and diagonal lines of light. The thickness of the channel is the same as the actual thickness of 3/4" plywood which allows for easy and fast installation in mill-work. The channel can be installed with magnets, clips or directly through the channel with the provided screws.

## DIMENSIONS

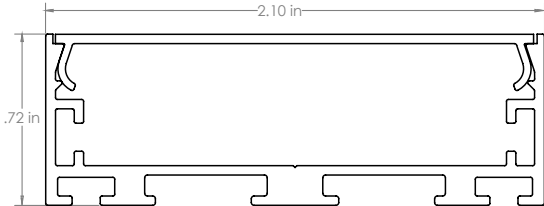

## LUMEN OUTPUT PERFORMANCE TABLE

Light Module	Color Temperature			
	2700K	3000K	3500K	4000K
2ZGBL (4 W/ft)	235 lm	240 lm	243 lm	258 lm
2ZGBM (8.8 W/ft)	500 lm	505 lm	525 lm	536 lm

**Note:** Results were obtained using a 1ft sample with diffused lens

## ORDERING CODE

Example: **ZNLT-SM2-2G-14-2ZGBM-24V-95C-27K-DLNS2G-MG**

Product	Length	Light Module   Cuttable Length   Watts Per Feet	Voltage	CRI	Housing Finish
ZNLT-SM2-2G			24V	95C	
ZNLT-SM2-2G	XX Length In Inches Only  <b>Note:</b> Lengths can be specified down to 0.25 inch.	2ZGBM ZIGBEAM   1.2 inch   8.8 W/ft 2ZGBL ZIGBEAM Low   1.2 inch   4 W/ft	24V- 24V	95C ≥ 95 CRI	AL Aluminum ( <b>Default</b> ) WH White Powder Coated BK Black Powder Coated XX Custom Color * RAL#:  *consult factory for availability

Color Temperature	Lens	Drivers	Mounting
27K 2700K 30K 3000K 35K 3500K 40K 4000K	CLNS2G Clear (1.13) * DLNS2G Diffused OLNS2G Opal (0.74) *  * Lumens/Foot get multiplied with the factor in parenthesis	MG (1% Magnetic Dimming) ZO (1% 0-10V Dimming) NN Non Dimming L3 Lutron Hi-lume 1% 3-wire/ EcoSystem (40W max.) LP Lutron Hi-lume Premier 0.1% FadeToBlack Eco System/3-wire	SCCL Scew in Clips * MGCL Magnetic Clips *  *Sets of 2

## ■ PRODUCTION OPTIONS (Optional for Lighting designers)

### OPTION A

Ship channels in 8ft lengths  
(Default for lengths greater than 8 ft)

Note: It will exclude any non-45 degree angles required, which must be cut by PreciseLED factory.

### OPTION B

Precut channels to desired lengths  
(Default for lengths less than 8ft)

Note: Exact field measurements must be provided, factory does not take responsibility for field measurement errors.

### OPTION C

Ship fixture preloaded with LED module

Note: This option is only available for lengths  $\leq 8$  ft. Exact field measurements must be provided, factory does not take responsibility for field measurement errors.

Note: The maximum length of a single channel is 8ft. For runs that are longer than 8ft, multiple 8ft channels need to be join together by means of straight channel connectors. Seamless lenses can be shipped in rolls of lengths up to 40 feet.

## ■ FIXTURE COMPONENTS

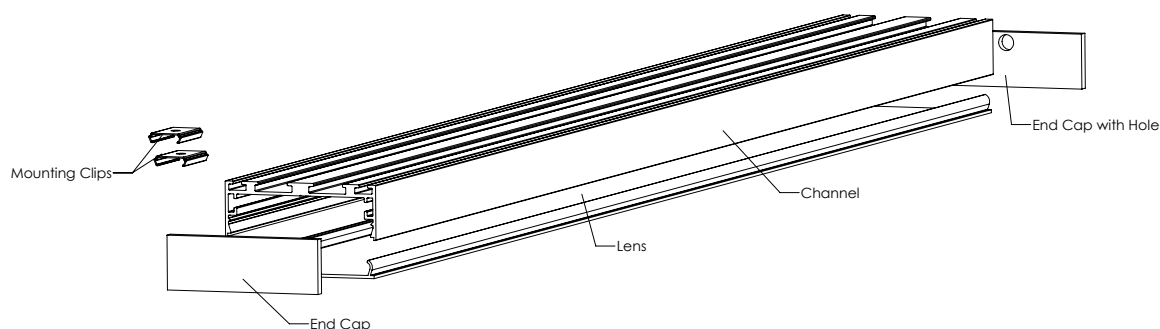

## ■ ASSEMBLED VIEW

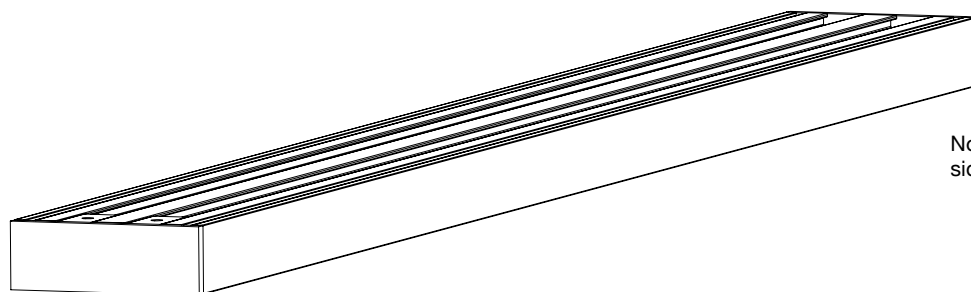

Note: Lead wire will either come out from side or back of channel

## ■ SPECIFICATIONS

### LED SYSTEM

- LED ENGINE: 2700K, 3000K, 3500K, 4000K  
ZIGBEAM: World's first miter-able tape light and dimmable using a dimmable driver. It displays a clean line of light at the surface of the lens.
- CRI: Minimum 95 color rendering index
- COLOR CONSISTENCY: 3-step binning LEDs
- OPTICS: Polycarbonate lens with clear, diffused, or opal lens available and field changeable. Able to run continuously up to 40ft for straight installations.

### ELECTRICAL

- STANDARD DRIVER: 120-277VAC, drivers are mounted remotely.  
MG: Forward phase 1% magnetic low voltage dimming (dims down to 1%) and flicker free  
ZO: 1% 0-10V dimming, flicker free, and IP65 rated for both indoor and outdoor use  
NN: Non dimming, flicker free, and IP65 rated for both indoor and outdoor use  
LUTRON DRIVER L3: Hi-lume 1% EcoSystem 3-Wire Driver, provides continuous and flicker free dimming from 100% to 1%.  
LUTRON DRIVER LP: Hi-lume Premier 0.1% FadeToBlack EcoSystem 3-Wire Driver, provides continuous and flicker free dimming down to 0.1% when used with EcoSystem Lutron controls.
- FEED: 18" of wire provided with connection to a longer wire inside the beginning module.

### MOUNTING

- Mounting brackets and/or screw in clips are provided to be attached to the channel allowing for the channel to be mounted directly into the ceiling/wall. This design is versatile for any location and easily moved.

### CONSTRUCTION

- DIMENSIONS: 2.10"W x 0.72" H
- HOUSING: Anodized aluminum extrusion cut with high precision equipment with up to 98% reflectivity on the inside.
- HOUSING FINISH: Powder coated white by default; with black available, and the option for custom colors. This provides the channel with a smooth finish and a defined color.

### LISTING/WARRANTY

- WARRANTY: 5 year limited warranty, ambient temperatures at fixture location should not exceed 40°C during normal operation.
- IP Protection: IP20
- CRI  $\geq$  95
- 50,000 hours lamp life
- US & International Patents Pending

## ■ ADDITIONAL COMPONENTS

There are certain standard components that comes along the ZENLITE® Lighting system as follows:

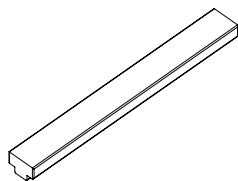

**T-shape Connector**  
Length: 2 inches  
Purpose: To connect to straight ZENLITE® Channels  
Part #: **ZNLT-CNCT-STRT**

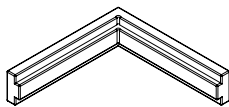

**Outside T-shape Connector**  
Length: 1 x 1 inches  
Purpose: To connect to straight ZENLITE® Channels at outside wall corners at 90 deg  
Part #: **ZNLT-CNCT-OS90**

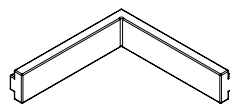

**Inside T-shape Connector**  
Length: 1 x 1 inches  
Purpose: To connect to straight ZENLITE® Channels at inside wall corners at 90 deg  
Part #: **ZNLT-CNCT-IN90**

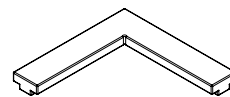

**ZIGZAG T-Shape Connector**  
Length: 1 x 1 inches  
Purpose: To connect to straight ZENLITE® Channels trimmed at 45 Degrees to form a 90 Degree bend  
Part #: **ZNLT-CNCT-ZG90**

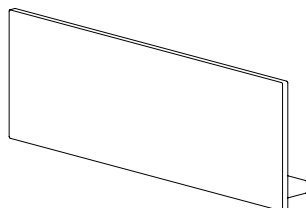

**End Cap**  
Purpose: To be attached at the beginning of ZENLITE® channel  
Part #: **ZNLT-SM2-EDCP**

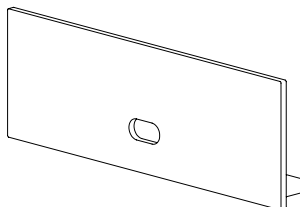

**End Cap With Hole**  
Purpose: To be attached at the end of ZENLITE® channel, and hole for lead wires to come out.  
Part #: **ZNLT-SM2-EDCPH**