

# ZENLITE® FLOAT ARC

## Instruction Sheet

- For your safety, read and understand instructions completely before starting installation

**Note:** PreciseLED fixtures are designed to meet the latest NEC requirements and are listed in full compliance with UL 1598. Before attempting installation of any lighting fixture, check your local electrical building code. This code sets the wiring standards and installation requirements for your locality and should be understood before starting work. If fixture is to be switch from wall switch or dimmer, make sure black supply wire properly connected to switch or dimmer (follow switch/dimmer instructions).

- **WARNING:**

1. Before wiring to power supply, turn off electricity at the fuse or circuit break box.
2. Insulation may be placed in direct contact with ANY part of the fixture.
3. Always have installation performed by a licensed electrician.

- **FIXTURE INSTALLATION**

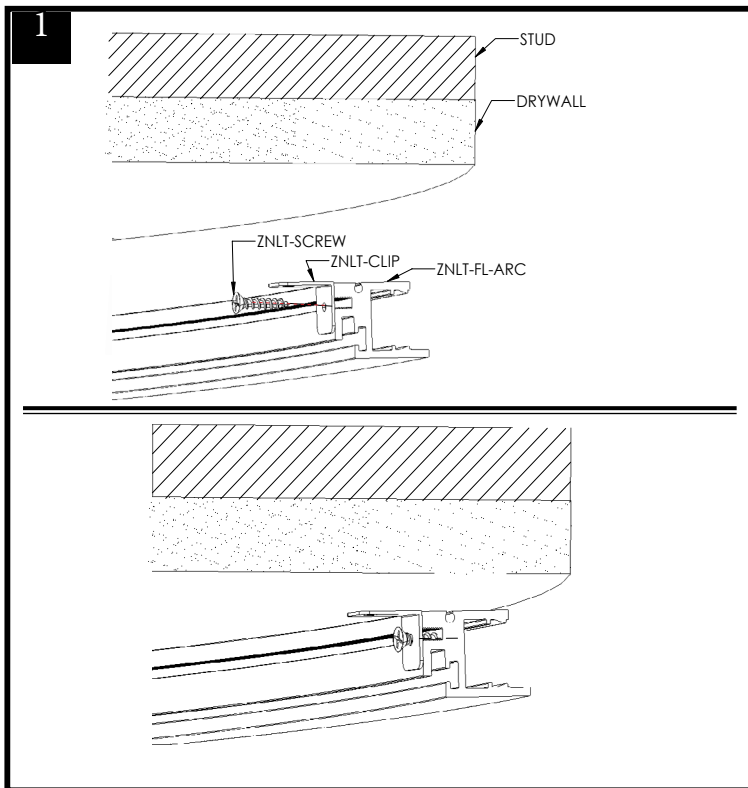

1. Attach Zenlite Mounting Clips to back of the Zenlite Float Arc channel with Zenlite M3 Screws, ensuring that clips are located to align with studs.

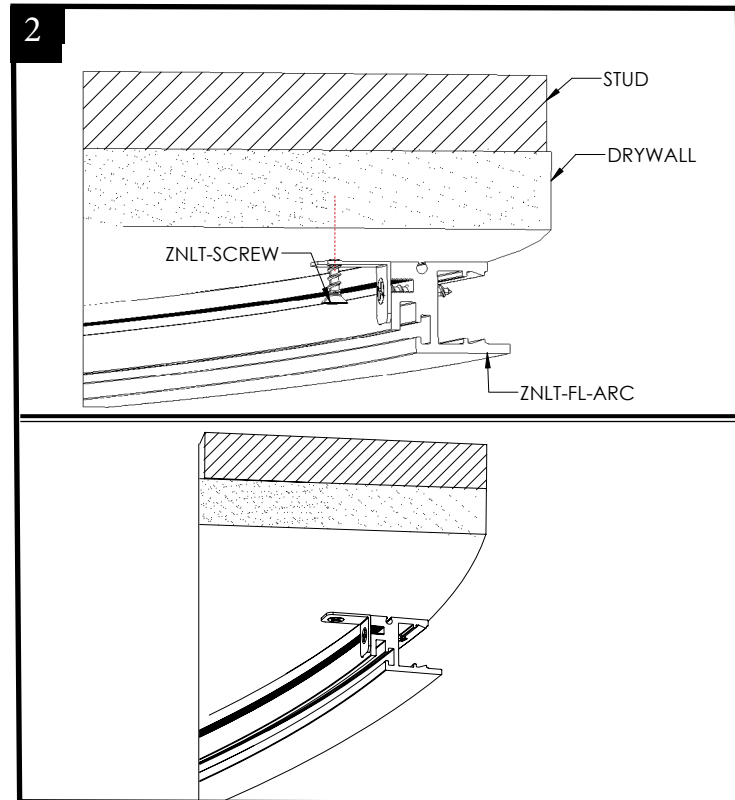

2. Align Zenlite Float Channel with the drywall and use self tapping Zenlite Screws to attach the channel to the studs. (Drill hole in Drywall to allow for power feed to pass through. See step 4)

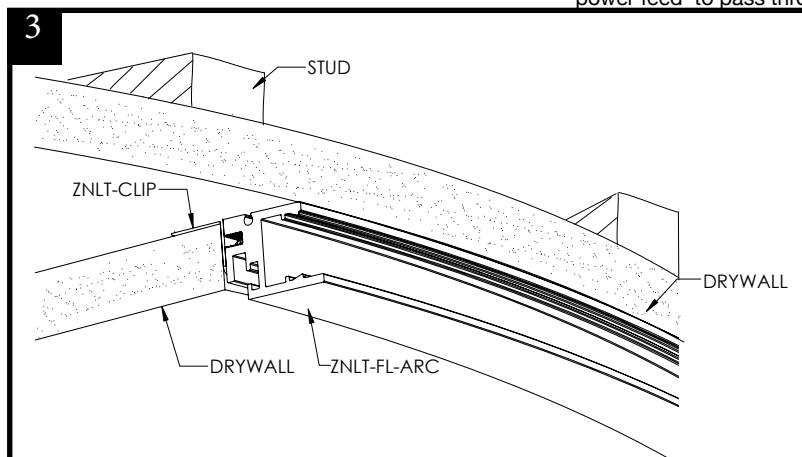

3. Install drywall over the Mounting Clips.

# ZENLITE® FLOAT ARC

## Instruction Sheet

4

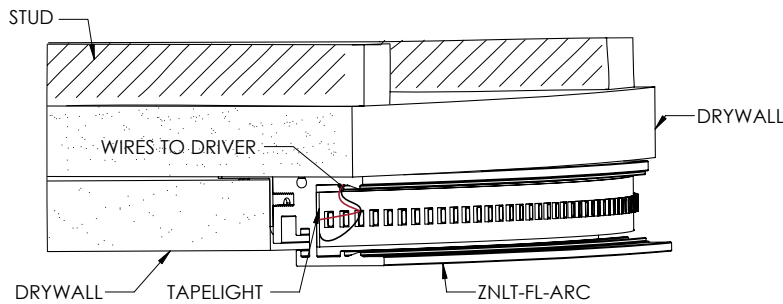

4. Remove adhesive backing on tapelight and center and place onto the back of the channel. (Wire the fixture to the driver according to the wiring diagram below.)

5

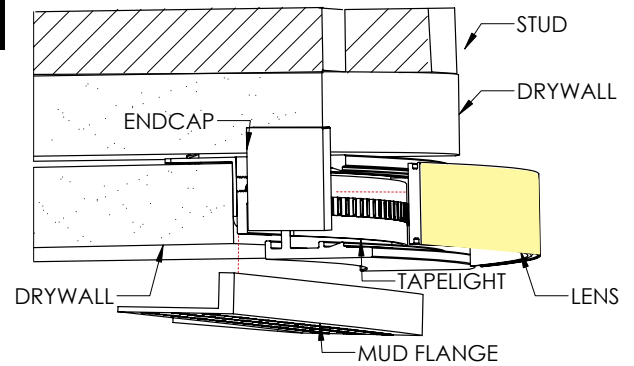

5. Install the Mud Flange into the appropriate Mud Flange Groove. Install Lens and Endcaps as shown. Apply plaster compound and spackle to complete installation.

### ■ WIRING DIAGRAM

Wiring diagram for a typical installation of the light fixture with a compatible driver and switch.

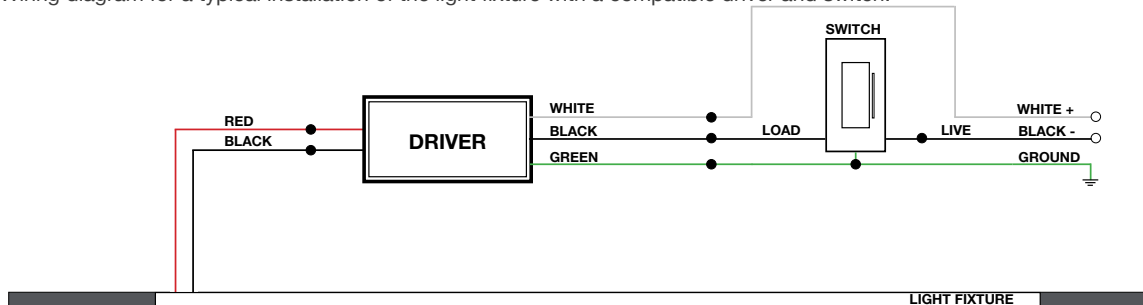

# ZENLITE® FLOAT ARC

## Instruction Sheet

### ■ INSTALLATION INSTRUCTIONS FOR (OPTIONAL) ZENLITE FLOAT REFLECTOR

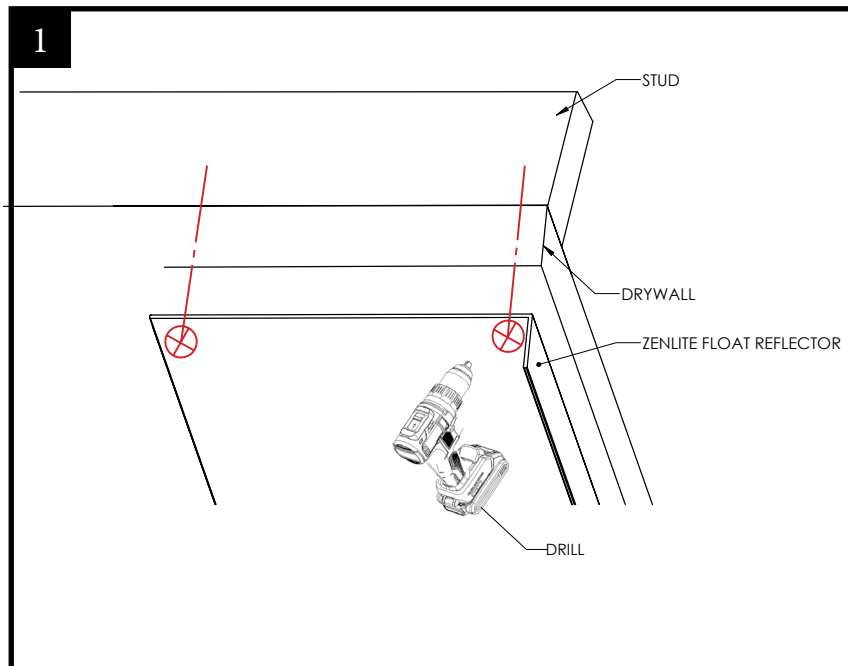

1. Drill holes in the edge of the Zenlite Float Reflector, aligning them with stud locations in the drywall ceiling.

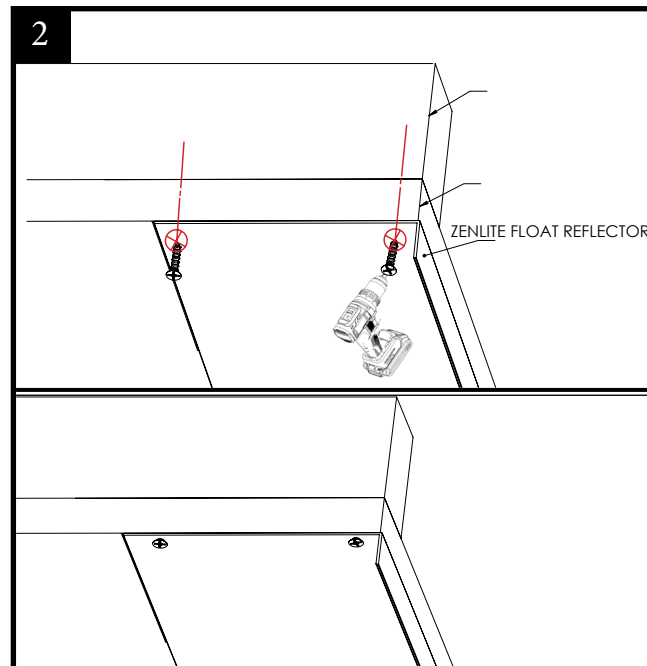

2. Use self-tapping Zenlite Screws to secure reflector to studs through dry wall.

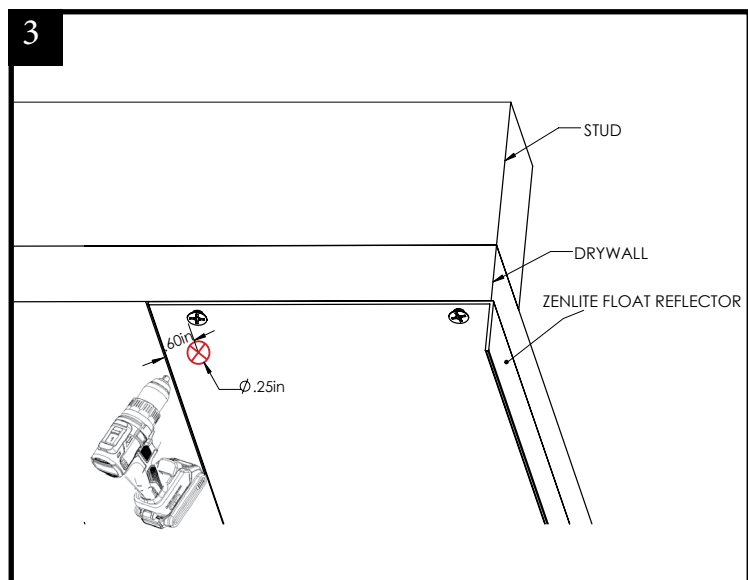

3. Once mounted drill a 1/4" hole in reflector approximately 0.60 inches away from the edge for the power feed to pass through. Continue with the installation of the channel.